

PLAY-YARD RENEWAL PROJECT SPONSORSHIP REQUEST

Woodroffe Avenue Public School

235 Woodroffe Avenue
Ottawa, ON K2A 3V3



Due to the removal of the play-structure in our primary (grades 1-3) yard in the summer of 2011, we have an urgent need to raise funds to replace the structure and revitalize the entire yard. We aim to fulfill the expressed needs of the students, teachers and parents of the school by creating a playful and safe environment in which an appreciation for nature can be nurtured. An outdoor classroom, more shade, new play equipment, and a garden in the courtyard are a few examples of what we hope to achieve. The entire community stands to benefit, beyond the 470 families that are represented in our school body. Only through the generosity of our families and community can our dreams be accomplished. Please consider supporting this worthy endeavor.

Why the Primary Yard Needs Renewal

The impetus for the renewal of the primary yard at Woodroffe Avenue Public School (WPS) is that the play structure in the primary yard was removed in July 2011. The children are left with three vast areas – grass, sand and pavement – to play without any guidance and encouragement in the environment for different types of play. It has been found that leaving vast open space, that do not encourage various types of play (both active and passive), leads to the need for increased surveillance, conflict and accidents¹.

Project Goals

The primary goal of the Primary Yard and Court Yard Renewal Project is to develop an outdoor environment for the students in Grades 1 to 3 that:

- Encourages physical activity and is a *playful environment* that encourages various different types of play but also provides areas for children who desires more passive and *quiet spaces* for play;
- Is *safe* – ensuring current standards are met, and appropriate surfaces are provided for play (e.g. grass area for soccer), and that the design enhances the children’s comfort from exposure to the heat and sun;
- Encourages an *appreciation for nature* through play in the natural environment; and

¹ Ann Coffey (2006). *A Guide to Transforming School Grounds*. Canadian Biodiversity Institute.

- Provides teachers with an *area for outdoor learning* (which could be used by the entire school).

The project also aims to develop the area in the courtyard into a safe and comfortable area where children of grades 1 to 6 can mingle and play together.

Survey

In the initial stage of this project, a survey of students, teachers and parents was conducted. The survey results concluded that more shade (in primary yard and courtyard), a play structure, an outdoor classroom and the reclaiming of more green space are desired. From the results it was concluded that the primary yard plan should aim to incorporate the following areas:

- Play structure or play structures (it would be desired to find ways to spread out the structure or have multiple structures to accommodate the size of the student population);
- Shaded area to incorporate outdoor classroom and quiet play;
- Imaginative play areas;
- Larger field for soccer type activities during classroom or recess time;
- Smaller open areas for other active play like tag;
- Sand area (which may be worked into play structure area or other equipment area);
- More inviting use of play pavement area; and
- Enhancing the courtyard with things like benches and/or garden, and providing extra shade in this area.

A diagram of the plan that has been proposed to meet the above criteria is on the last page of this sponsorship request packet.

How the project benefits the community

Woodroffe Avenue Public School is an integral and vital part of serving the needs of families in the McKellar Park, Carlingwood, Woodpark, McKellar Heights, Whitehaven, Britannia and Lincoln Heights communities. 470 families are represented in the student body. We believe that by improving the quality of life of each individual student, we improve the quality of life within each family. This indirectly leads to stronger communities and stronger workplaces.

WPS encourages community groups to use their space, in accordance with the Ottawa Carleton District School Board (OCDSB) policy, as stated on their website: “In partnership with the Ministry of Education and Ministry of Tourism and Recreation, we are making school space more affordable and accessible in support of healthy, active lifestyles and helping to build vital communities that offer the residents within the District a higher quality of life.” Currently the following community organizations are using the school building and/or grounds: Woodroffe School-Age Program (City of Ottawa), YMCA After School Program, OCDSB International Languages Program, Al-Nour Arabic School, OCDSB Extra-Curricular Arts Program, Learn to Play, Adult Co-Ed Sports League, Ottawa Royals Soccer Club, Adult Volleyball, Lighthouse Volleyball, Girl Guides of Canada, and Day Care summer Program (City of Ottawa).

In addition to providing a stimulating and safe play area for students during the school day, the grounds of the school can be accessed by the public outside of the instructional day, i.e., after school, and when other leased users are not using the space. We anticipate increased usage by members of the community with the development of our proposed plans for renewal.

Multiyear Project Proposal: Estimated Cost and Means of Funding

Year 1

Project activity	Estimated cost	Initial funding targets and sources
(1) Landscaping: improve drainage, build mound, add topsoil and sod, plant trees	\$35K	Allocation from existing funds
(2) Install small play structure and play houses	\$35K	\$20K from fundraising activities \$15K from business donations
(3) Install large play structure and court yard garden	\$80K	Contingent on grants
Project subtotal	Up to \$150K	

Years 2+

Approximately an additional \$200K will be required for:

- Removing asphalt, and replacing with an artificial turf soccer field
- Outdoor classroom, with gazebo, bench seating and a stage

Option A: 5 year project - \$50K per year for 4 years

Option B: 3 year project - \$100K per year for 2 years

Contact Information:

More information can be accessed at the Woodroffe School Council website:
<https://www.wapscouncil.org/display/wapsc/Primary+Play+Yard+Development>

You may also contact the Playground Renewal Coordinator, Jean Byrne, via
wapscouncil.playyard@gmail.com.

Donation Recognition

We would greatly appreciate a financial donation of any amount. The following table states the benefits your company may expect to receive from sponsoring to this project.

Corporate Donor Recognition

	Name on Shared Plaque on permanent display in school	Recognition on Thank You Banner	Named in school publications: newsletters, websites, bulletin board display*	Named in community publications**	Certificate of Appreciation	Tax Receipt
Platinum \$5000+	Yes	Large Color Logo or Name	Yes	Yes	Yes	Yes
Gold \$2500	Yes	Medium Color Logo or Name	Yes	Yes	Yes	Yes
Silver \$1000	Yes	Small Color Logo or Name	Yes		Yes	Yes
Bronze \$500	Yes	Name	Yes		Yes	Yes
Donor \$250		Name	Yes			Yes
Donor \$100			Yes			Yes

*listed with amount donated

**We will ensure that Platinum and Gold sponsors are mentioned in interviews with community newspapers and ask that they be mentioned by name in article.

In-kind donations of materials will be recognized as indicated above. In-kind donations of services and donations of gift certificates cannot be issued a tax receipt.

In-kind Donations

In-kind donations are also welcome! The following is a non-comprehensive list of materials and/or services of which we would be grateful to receive in whole or in part:

Asphalt removal (1115 sq. m.)	Wood mulch (50 sq. m.)
Sand removal (150 sq. m.)	Rubber Surfacing (100 sq. m.)
Wood timber edge/retainer removal (35 m)	Stonedust (250 sq. m)
Wood fibre (150 sq. m.)	Shade Trees (8)
Quality play sand (85 sq. m.)	Rock Seating Walls (20)
Artificial turf (965 sq. m.)	Stepping Stones (24)
TREX Decking (15 sq.m.)	Wood fencing (10 m)
Topsoil and Sod (375 sq. m.)	

All cheques can be made out to Woodroffe School Council with Playground specified on the memo line, and sent to:

Woodroffe Avenue Public School
Attn: Woodroffe School Council
235 Woodroffe Avenue
Ottawa, ON K2A 3V3

Please provide your full name and address so that a tax receipt can be issued for amounts of \$20 or more.

Appendix A

Proposed Courtyard Garden Layout

Size – 10 m x 10 m

Includes a large shade tree, 4 picnic tables and stepping stone pathways

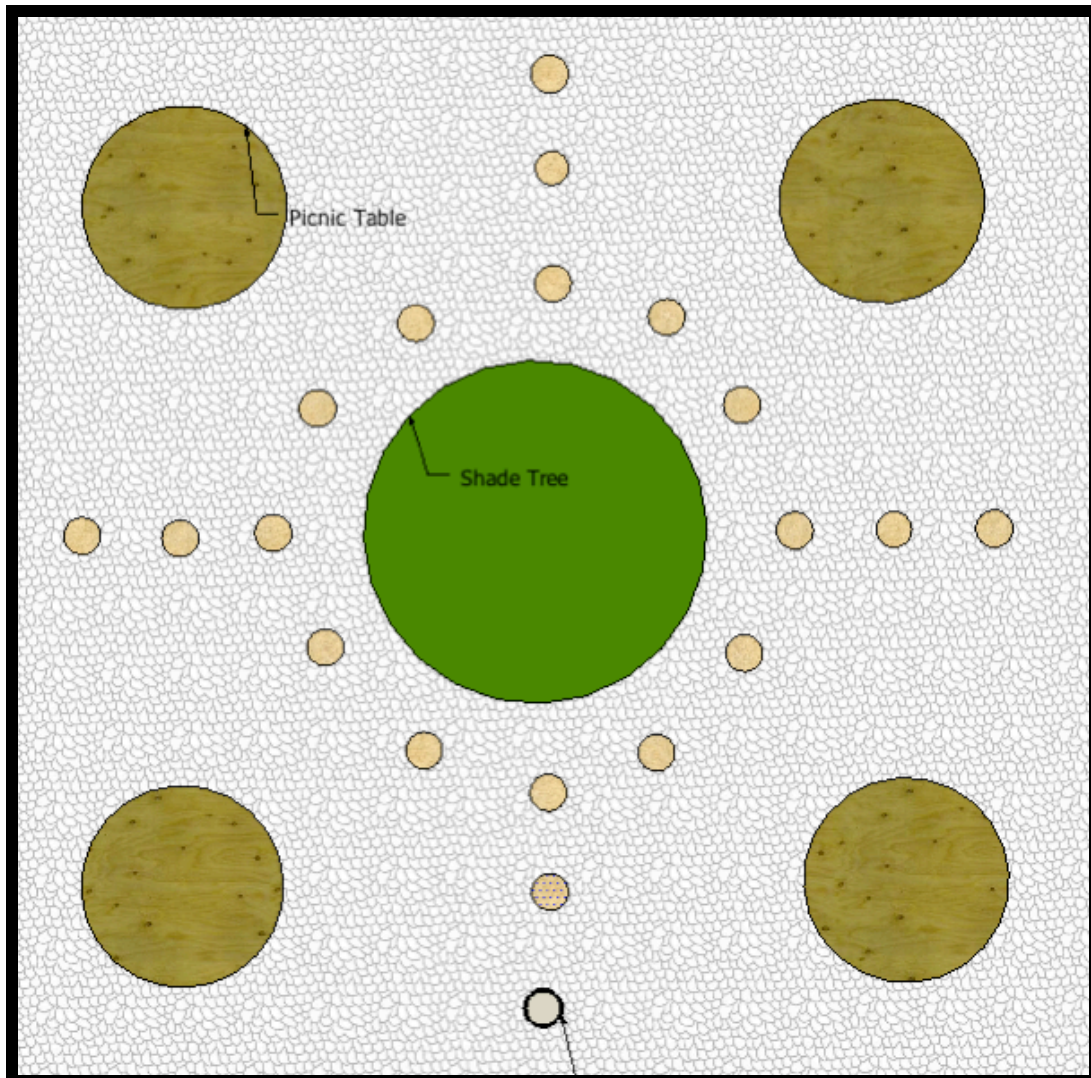

Appendix B
Proposed Primary Yard Re-development

